



### 8 Birdwood Avenue Norlane VIC

This clean industrial warehouse is ideally located, make the time to inspect now.

- \* 4 car parks onsite
- \* Building total size Approx. 244m<sup>2</sup>
- \* Office Approx. 24m<sup>2</sup>
- \* Land Approx. 665m<sup>2</sup>
- \* Greater Geelong Planning Scheme Industrial 1 Zone
- \* For Lease \$19,000 per annum plus GST and Outgoings

**Building Size** : 244 sqm  
**Land Size** : 665 sqm  
**View** : <https://www.mayfieldrealestate.com.au/lease/vic/geelong-district/norlane/commercial/industrial/5673047>



**Mark Mayfield**  
03 5272 1288

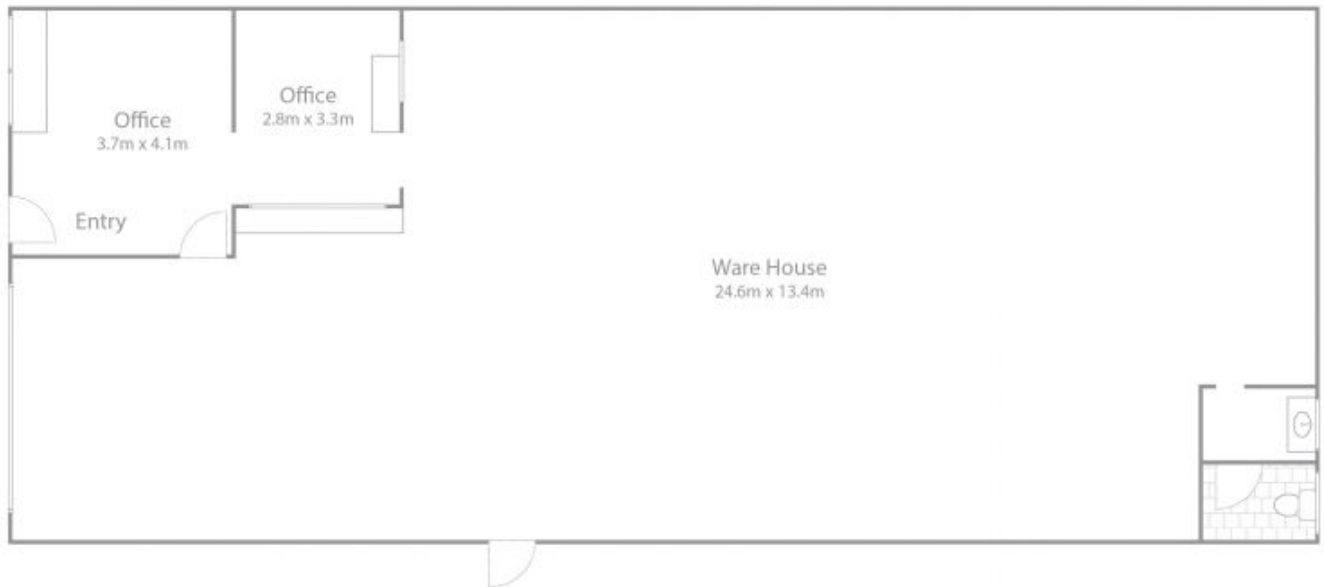

Whilst [bwm.com.au](http://bwm.com.au) has made every attempt to ensure the accuracy of the floor plan contained here, measurements are approximate and no responsibility is taken for any error, omission, or mis-statement. This plan is for illustrative purposes only.

**8 Birdwood Avenue, Norlane**





Site Plan

Whilst [bwrn.com.au](http://bwrn.com.au) has made every attempt to ensure the accuracy of the floor plan contained here, measurements are approximate and no responsibility is taken for any error, omission, or mis-statement. This plan is for illustrative purposes only.

**8 Birdwood Avenue, Norlane**

